

**easy detect**

Fire Security Products

Ref. 553550001
250703**EN**

Quick guide

Analogue push-button

1. Introduction

The analogue push-button provides the fire detection system with a manual alarm activation point.

The alarms activated by the push-button will be detected by the analogue alarm control panel.

The push-button module is suitable for indoor use and alerts its users to a fire in its early stages.

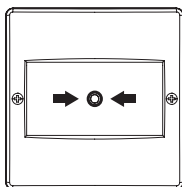

Analogue push-button with isolator	PAE-550-AI
Analogue push-button	PAE-550-A

2. Installation

The push-button module must be installed on the wall at a height between 0.8 and 1.2 metres from the floor and one must be placed at each exit of the site.

The distance between installed push-button modules must be no greater than 25 metres.

The fire protection system must be connected according to the following wiring diagram, always with the power supply disconnected.

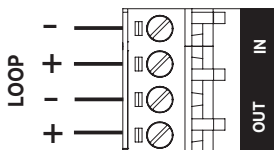

The push-button module does not require an auxiliary power supply, as it is powered directly from the loop.

Addressing

The push-button is part of the analogue system, and requires addressing so that it can be identified by the alarm control panel.

They can be numbered from 1 to 250 using the PGE-100 programmer and occupy a number of consecutive addresses in the loop equal to the sum of their inputs and outputs.

For numbering, insert the programmer cable into the push-button via the LOOP IN connector.

Resetting the push-button module

After it has been activated, the push-button module can be reset with the supplied key.

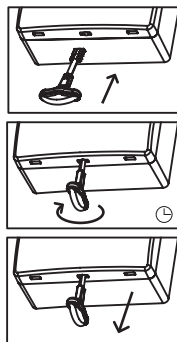

1
Insert the key

2
Turn the key 90°

3
Pull it outwards until you hear the activation "click".

3. Testing and maintenance

Push-button maintenance consists of performing a visual inspection of its condition and an activation test.

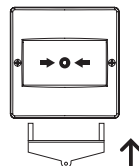

4. Technical characteristics

Push-button	Working voltage:	31 to 40 VDC
	Consumption on standby:	<300 µA
	Consumption during alarm:	<40 mA
	Type:	A-INDOOR USE
Wiring	2 × 1.5 mm ² twisted pair and shielded	
Environment	Working temperature:	From -10°C to 40°C
	Relative humidity:	95% non-condensing
	IP rating:	IP33
Physical characteristics	Dimensions:	98×98×48 mm.
	Material:	ABS
Certification	EN 54-11 / EN 54-17	

For detailed characteristics, scan the following QR code.

